

Traffic Control Plan:

Date: 07/03/2022 **Author:** Gemini Perera **Project:** 90-102 Regent Street, Redfern www.invarion.com
Client: Richard Crookes Construction **Contact:** Manny Kalach **Phone:** 0459 947 302

Comments:

This plan was designed by Gemini Perera of Roadside Traffic Management in accordance with Australian Standards and the TfNSW's Traffic Control at Worksites Manual V6.0. The plan is designed for the safe closure of Marian Street between Gibbons and Regent Street, the Southern end of William Lane, the kerb lane closure on Regent Street and the kerb lane on Gibbons Street for the setup of a 400T mobile crane to install the site tower crane at 90-102 Regent Street, Redfern. During work traffic and pedestrians will be detoured. Certified traffic controllers will be on-site to implement and monitor this TCP. All traffic control plans are copyright/property of Roadside Traffic Management and are not transferrable unless authorized by Roadside Traffic Management. Any questions please contact Gemini Perera of Roadside Traffic Management on 0400 350 182.



Manifest

- 87 x Cone
- 33 x Bollard
- 31 x Pedestrian Tape
- 10 x ImSTRAIGHTARROW
- 9 x sign single
- 8 x Traffic Controller
- 6 x TM5-V5 CHEVRON
- 2 x T1-18 PREPARE TO STOP
- 2 x T1-34 TRAFFIC CONTROLLER AHEAD
- 2 x T1-5 WORKERS AHEAD
- 2 x T2-4 ROAD CLOSED
- 1 x ImLEFTARROW
- 1 x ImRIGHTARROW
- 1 x R4-212 (40) SPEED LIMIT 40 ROAD WORK
- 1 x RESIDENTS residents only
- 1 x T1-6 DETOUR AHEAD
- 1 x T5-1 (F) DETOUR IN FRONT
- 1 x T5-1 (R) DETOUR LEFT
- 1 x W5-205 trucks turning
- 1 x Work Truck Left

Legend

- Bollard
- BUS STOP
- Cone
- Job Site
- Mobile Crane
- Pedestrian Access
- Pedestrian Tape
- semi trailer
- Site Carane
- Traffic Controller
- traffic light
- Work Area

Traffic Controllers to assist trucks entry/exit to site and manage the pedestrians activity.

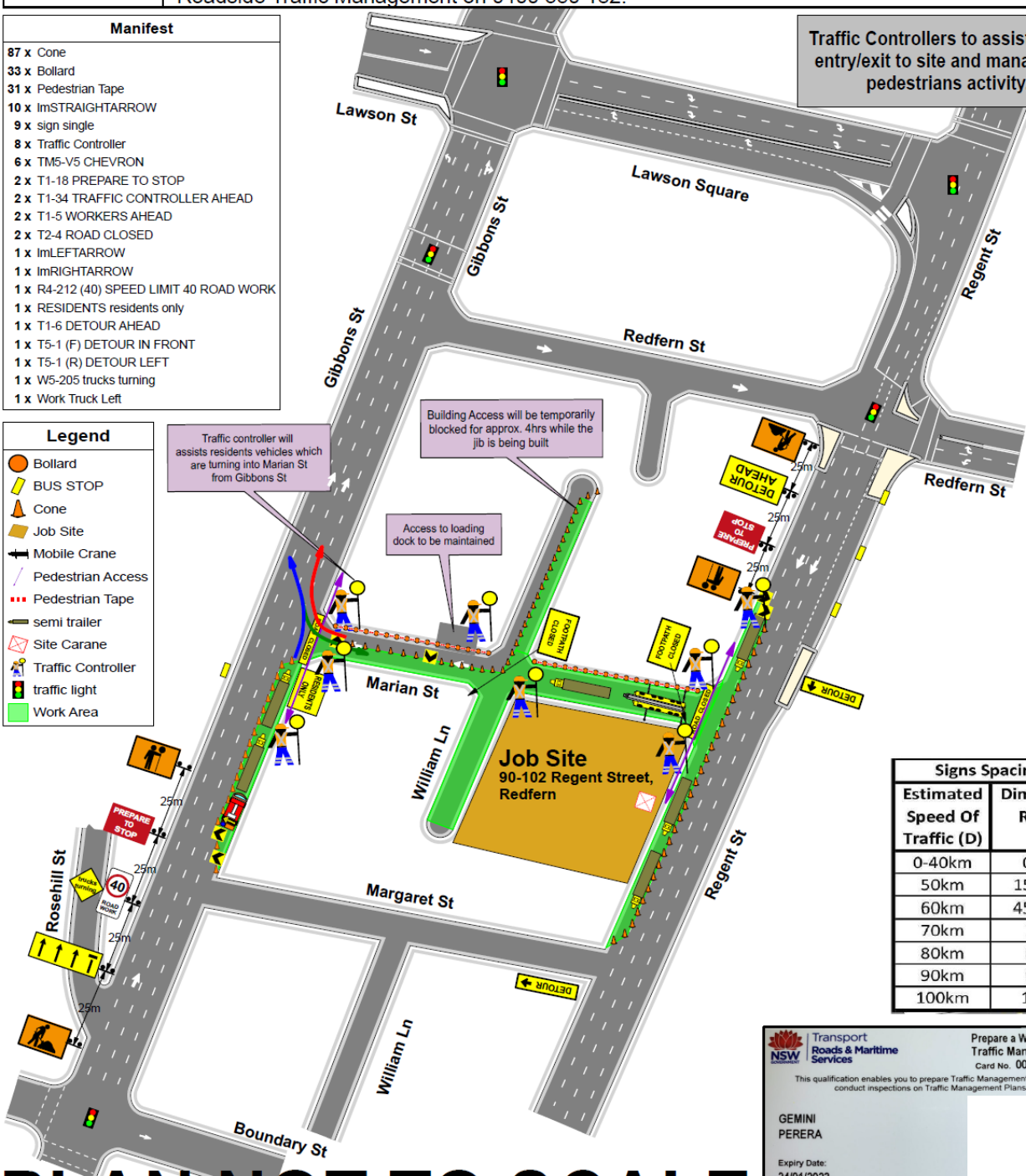

Signs Spacing's

Estimated Speed Of Traffic (D)	Dimension Range
0-40km	0-5m
50km	15-50m
60km	45-60m
70km	70m
80km	80m
90km	90m
100km	100m

NSW Transport Roads & Maritime Services

Prepare a Work Zone Traffic Management Plan
 Card No. 0052272002

This qualification enables you to prepare Traffic Management Plans and conduct inspections on Traffic Management Plans.

GEMINI PERERA

Expiry Date: 24/01/2023

This card is not a proof of identity.

PLAN NOT TO SCALE